

APPURTANCES DETAILED INFORMATIONS NOT SHOW ON SITE PLAN DUE TO SPACE RESTRICTIONS. GUIDE TO LEGEND USED:

SMH	CBMHNW5	CBMHCE5A
MH45	T319.70	T321.50
T321.30	N1316.48	E1318.36
E1318.98	S1316.45	V1319.33
V1318.95	E1316.48	S1318.36
SE1318.98	CBMHNW6	CBMHCE7
SMH	T320.90	T321.35
MH42	N1316.26	NV1319.62
T321.30	V1316.26	SV1319.62
E1318.98	S1316.23	SE1319.59
SE1318.98	CBMHNW8	CBMHCE9
V1318.95	T319.50	T321.45
SE1318.98	N1319.56	NV1319.42
CBMHNW1	V1319.56	V1319.42
T319.05	SE1317.50	E1315.56
SE1317.50	SV1317.55	SV1319.39
RECHARGE	CBMHSW4	MHHEC1
NV1317.30	T319.67	T321.46
CBMHNW2	S1317.04	NV1319.55
T319.95	E1317.04	E1317.91
NE1318.92	V1317.04	Drop to 314.74
V1318.99	MH8	V1314.44
CBMHNW3	CBMHCE4	MHHEC2
T319.67	T321.40	T319.38
E1317.38	E1318.83	MH7
V1317.13	N1319.05	T319.40
S1317.10	V1318.89	E1314.38
CBMHNW4	CBMHCE5	MHSCS5
T319.65	T321.86	T319.40
N1316.67	N1318.67	T319.40
NV1316.67	V1318.67	E1317.90
SE1316.64	S1318.64	V1317.87

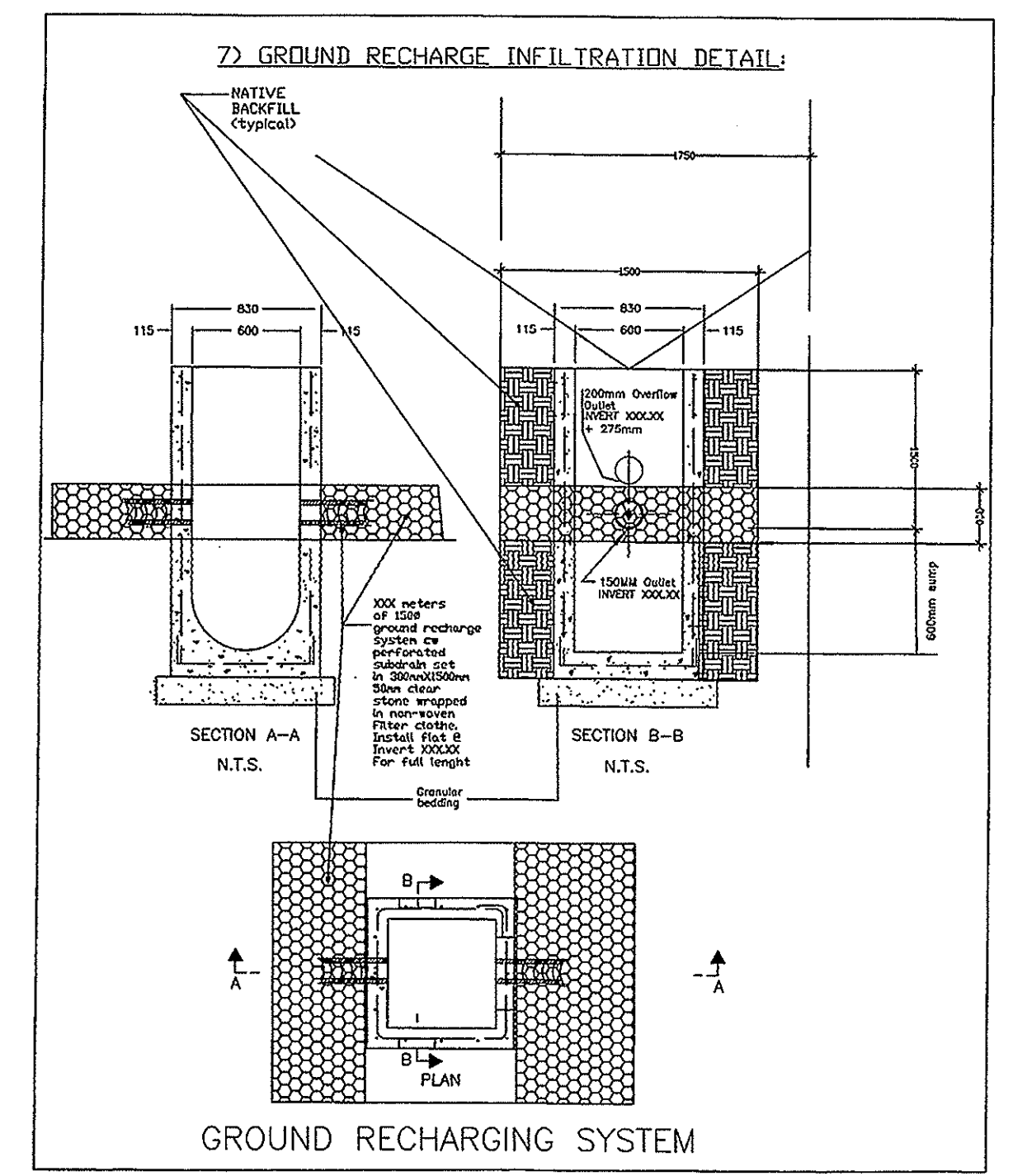

GENERAL NOTES:

- 1) FOR DETAILED DESIGN OF UNDERPASS & SILVERCREEK GRABBING & DRAINAGE & CITY OF GUELPH EASEMENT STORM & SANITARY UNDER THE HANLON PARKWAY DESIGN REFER TO THE ENGINEERS & ARCHITECTS & PLANNERS' DESIGN DRAWINGS.
- 2) ALL WORK WITHIN THE CITY OF GUELPH R.O.W. SHALL BE CITY FORCES UPON APPLICATION.
- 3) IT IS THE OWNER'S RESPONSIBILITY TO CONDUCT ROUTINE MAINTENANCE OF GROSS TRAPS & / OR ANY OTHER GIL / GRIT SYSTEMS INSTALLED ON THE OWNER'S PROPERTY.
- 4) DETAILED EROSION & SILT CONTROL DRAWINGS SHALL BE SUBMITTED TO THE CITY OF GUELPH PUBLIC WORKS DEPARTMENT TO THEIR SATISFACTION AT TIME OF SITE PLAN APPROVAL APPLICATION.
- 5) CONTROL FLOW ROOF DRAINS: SEE DETAIL OF DRAIN ON SP4 OF 4 & IN SWM REPORT.
- 5.0) RELEASE RATE OF EACH CONTROL FLOW DRAIN SHALL BE 1 L/S FOR THE 5 YEAR STORMS & 1.5 L/S FOR THE 100 YEAR STORMS FOR NUMBER OF CONTROL FOR EACH BUILDING IS NOTED ON THE DRAWING & IN THE SWM REPORT.
- 5.1) FOR EXACT LOCATIONS OF DRAINS REFER TO ARCHITECTURAL, STRUCTURAL & MECHANICAL DRAWINGS.
- 5.2) ROOFS SHALL BE CAPABLE OF STORING A MAXIMUM OF 150 MM AND AN AVERAGE OF 100MM.
- 5.3) PERIMETER OVERFLOW SCUPPERS SHALL BE INSTALLED ON EACH BUILDING TO LIMIT THE MAXIMUM 150MM OF STORAGE ON EACH ROOF. ONE MINIMUM 300MM WIDE X 150MM HIGH FOR EACH ROOF DRAIN.
- 6) ALL SANITARY MANHOLES LOCATED IN SWM PONDING AREAS TO HAVE WATER TIGHT LIDS.

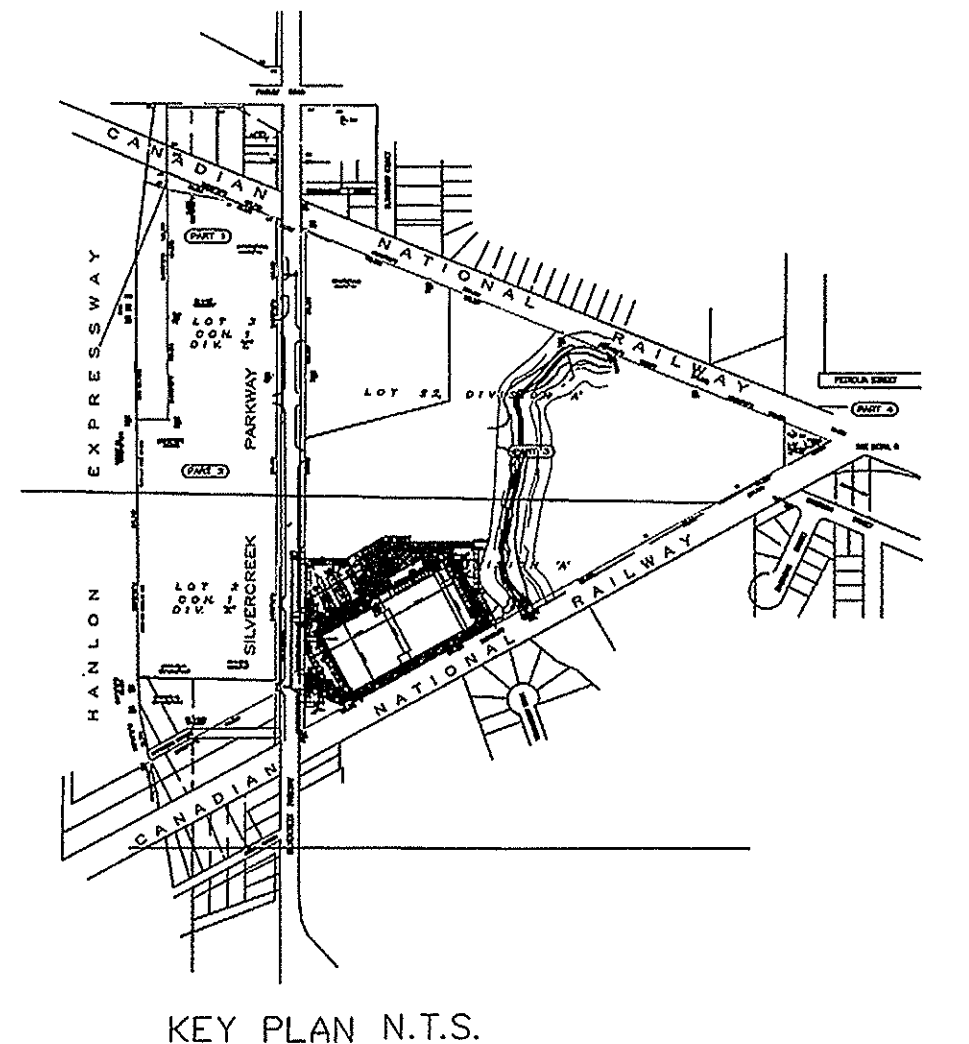

EROSION & SEDIMENTATION

- 1) All silt fencing to be installed prior to any grading, excavating, or demolition commencing.
- 2) Erosion control fencing to be installed around the base of all stockpiles.
- 3) Erosion protection to be provided around all storm & sanitary MH's and CB's.
- 4) Additional erosion controls may be required as the site progresses, contractor to provide all additional erosion control structures.
- 5) The consultant is to monitor erosion control structures to ensure fencing is installed & maintenance is performed to City requirements.
- 6) Erosion control structures to be monitored regularly and any damage repaired immediately. Sediments to be removed when accumulation reach a maximum of 1/2 the height of the silt fence.
- 7) All erosion control structures to remain in place until all disturbed ground surfaces have been stabilized either by paving or restoration of vegetative ground cover.
- 8) No alternative methods of erosion protection shall be permitted unless approved by the consultant and the City of Guelph Works Department.
- 9) The contractor is responsible for municipal road way to be cleaned as all sediments from vehicular tracking etc., at the end of each workday.



NO.	DATE	REVISIONS	BY
12	01/02/08	Submitted to Guelph for Resolved application	PVA
10	08/02/07	Submitted to Guelph for Resolved application	PVA
8	04/20/06	Submitted to Guelph for Resolved application	PVA
5	04/07/04	Submitted to Guelph for Resolved application	PVA
4	03/25/04	Submitted to Guelph for Resolved application	PVA
3	03/23/04	Submitted to Guelph for Resolved application	PVA
2	03/22/06	ISSUED FOR DISCUSSION WITH GROW	PVA
1	02/28/06	ISSUED FOR DISCUSSION	PVA

DRAWING ISSUE

DATE	PARTICULARS	BY
09/02/03	Issued for Design Approval	PVA
09/08/03	Issued for Site Plan Approval	PVA
	Issued for Pricing and Budgeting	
	Issued for Building Permit	
	Issued for Tendering	
	Issued for Construction	
	Issued for Record Set of Docs.	

THIS DRAWING IS THE PROPERTY OF PVA CONSULTANTS LIMITED AND IS SOLELY ISSUED FOR NEGOTIATIONS BETWEEN PVA CONSULTANTS AND THE CLIENT. NO FURTHER USE OF THIS DRAWING CAN BE MADE WITHOUT THE WRITTEN CONSENT OF PVA CONSULTANTS.

DO NOT SCALE THIS DRAWING. ALL DIMENSIONS SHALL BE OBTAINED FROM THE ARCHITECTURAL CERTIFIED DIMENSIONS.

ANY AND ALL DISCREPANCIES OR PERCEIVED DISCREPANCIES SHALL BE IMMEDIATELY REPORTED TO PVA CONSULTANTS FOR WRITTEN CLARIFICATIONS AND/OR INSTRUCTIONS.

THIS DRAWING TO BE VALID MUST BE CERTIFIED (STAMPED AND SIGNED) BY A PROFESSIONAL ENGINEER BEFORE ISSUED.

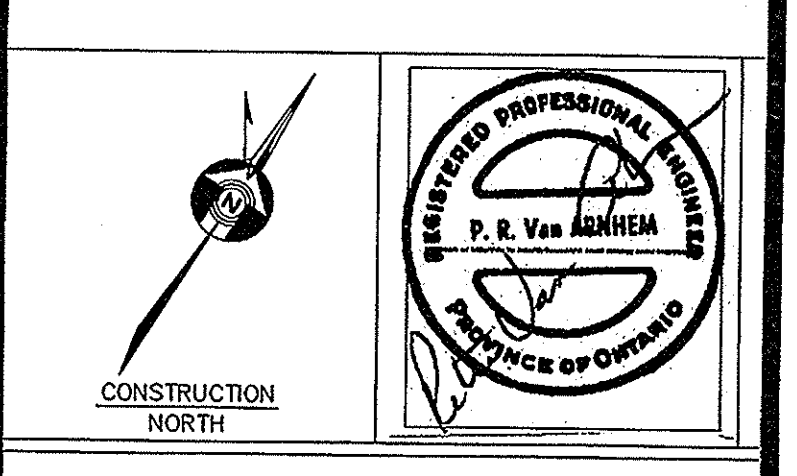

PVA
PVA CONSULTANTS LIMITED
496 INDIAN ROAD
BURLINGTON, ONTARIO
L7T 3T3
PH: 1-905-681-7966
FAX: 1-905-333-4944
email: pvanarnhem@cogeco.ca

CLIENT: SILVERCREEK DEVELOPMENTS (GUELPH) LIMITED

PROJECT: SILVER CREEK JUNCTION MARKETPLACE

DRAWING NAME: SITEPLAN-PRELIMINARY CIVIL UNDERGROUND HOWITT CREEK 1-100 YR ATTENUATION POND

SCALE: 1:750 DATE OF Dwg: FEB 2006 PROJECT NO: 0507

DRAWN BY: PVA SHEET NO. CSP2-E REV. NO. OF 4

CONTRACTOR TO PROVIDE INSULATION COVER FOR ALL STORM AND SANITARY LINES FROM MAIN UNDERPASS (GROUND COVER LESS THAN 1.5 METERS) THROUGH INSTALLATION TO BE AS PER PLAN AND AS PER SP5 AND SP4.

LEGEND

- EX SANITARY MANHOLE
- EX STORM MANHOLE
- NEW STORM MANHOLE
- CATCH BASIN
- SIAMENSE CONNECTION
- HYDRANT VALVE & BOX
- HYDRANT VALVE & BOX
- WATERMAIN
- STORM SEWER
- SANITARY SEWER
- LIMIT OF CONSTRUCTION
- PLUG
- VALVE AND VALVE BOX
- PROPERTY BOUNDARY
- HEAVY DUTY ASPHALT
- OVERLAND FLOW
- EXISTING ELEVATIONS
- PROPOSED ELEVATIONS
- PAINTED ISLAND
- CONCRETE CURB
- ALL EXISTING SERVICES IN GREY
- EXISTING ELEVATIONS TO REMAIN
- PROPOSED ELEVATIONS BOTTOM OF CURB, ADD 150mm TO OBTAIN TOP OF CURB UNLESS INDICATED OTHERWISE
- PROPOSED ELEVATIONS TOP OF CURB, DEDUCT 150mm TO OBTAIN BOTTOM OF CURB UNLESS INDICATED OTHERWISE
- BENCHMARKS: N/A
- D.C. = DEPRESSED CURB
- CATCH BASIN AND CBMH
- TOPOGRAPHIC SURVEY PRODUCED BY: VAN HARTEN SURVEYORS GUELPH, ON. DATE: FEBRUARY, 2006
- CONTROL POINTS
- TEMPORARY BENCHMARKS
- SWM PONDING
- MAXIMUM PONDING (PLUGGED DRAIN)

ALL CURBS (TYPICAL) AS PER DP3D 600110 SEE DETAIL (UNLESS OTHERWISE SPECIFIED)

NB: ALL CB'S AND CBMH'S TO HAVE 3 METER DRAINAGE SPIGOTS SEE ALSO DETAILS ON SP4